

ITEM	P/N	QTY	
1	000290-05	1	KIT, LED STROBING - RED, W/ SPACERS
2	000193SAE	4	LENS GASKET, 1/16" CORK RUBBER
3	000185STF	8	BOLT, #6-32 X 1.25 HX HD, TYPE F
4	-	1	BOX, B2
5	-	1	LABEL
6	-	1	INSTRUCTION SHEET

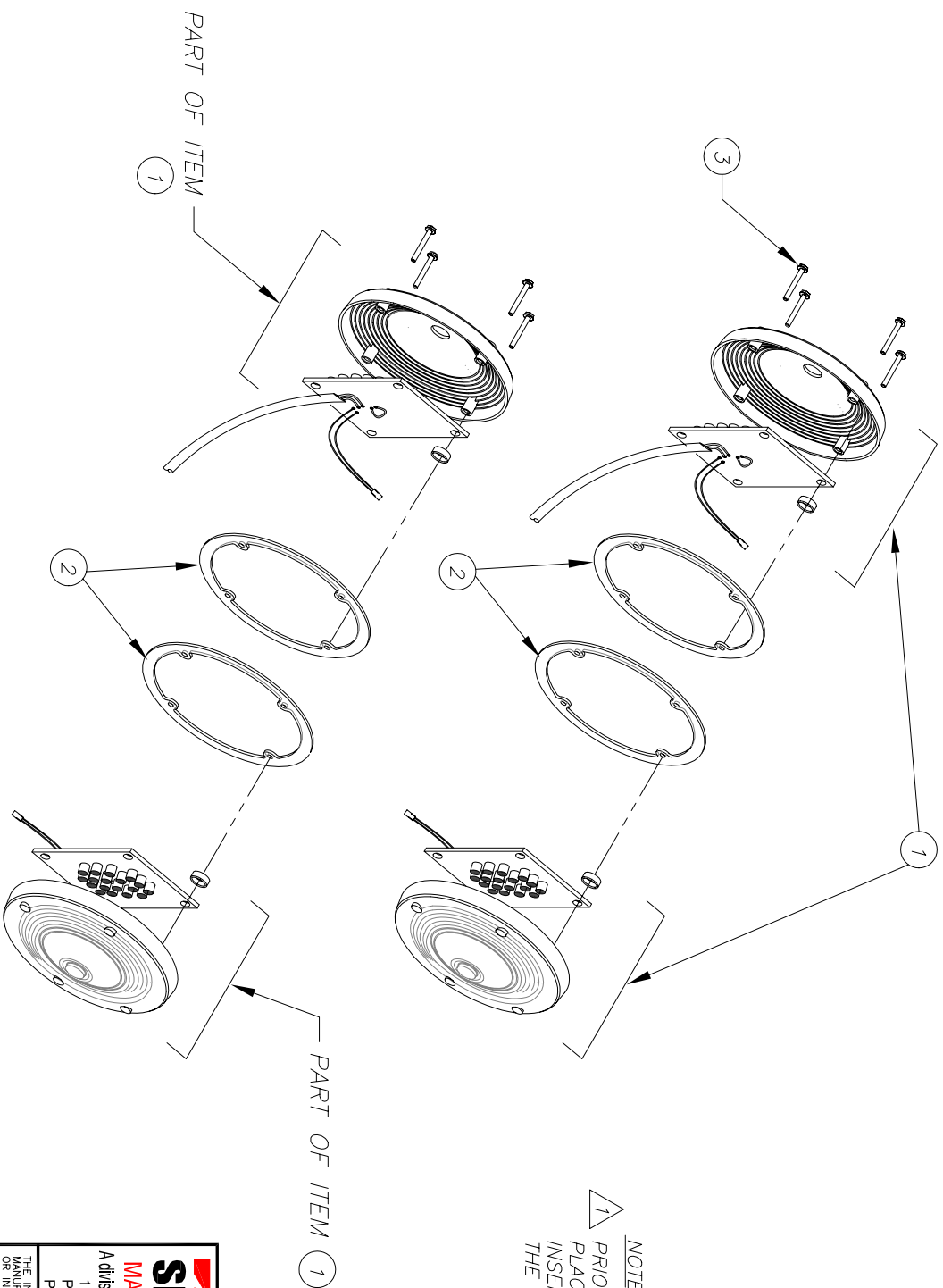

## GENERATION II



**NOTE:**  
 PRIOR TO SHIPPING:  
 PLACE LABEL ON THE BOX.  
 INSERT ALL THE PARTS ALONG WITH  
 THE INSTRUCTION SHEET IN THE BOX.

REV.	DATE	BY	NOTES

**SPECIALTY MANUFACTURING CO.**  
 A Division of The Ellison Company, Inc.  
 10200 PINEVILLE ROAD  
 P.O. BOX 790  
 PINEVILLE, NC 28134

DRAWN BY: CGM DATE: 3/16/06  
 MATERIAL: SELE BOM  
 FINISH: —  
 SCALE: 1 OF 1 SHEET SIZE A  
 TOLERANCES (EXCEPT AS NOTED)  
 DECIMAL: .XXX ± .010 XX ± .03  
 ANGULAR: ± 1°

THE INFORMATION CONTAINED HEREIN IS THE PROPRIETARY DATA OF SPECIALTY MANUFACTURING CO., AND IS NOT FOR DISSEMINATION OR DISCLOSURE IN WHOLE OR IN PART FOR ANY PURPOSE OTHER THAN THAT FOR WHICH IT IS SUBMITTED, EXCEPT AS EXPLICITLY AUTHORIZED IN WRITING BY SPECIALTY MANUFACTURING CO.

DESCRIPTION: KIT, LED STROBING STOP ARM

DIRECTORY: C:/ACAD/MAIN	DRAWING/PART NO. 000290	REV. —
FILE NAME: 000290		